

Quick Installation Guide

Models:
S22-M-H
S22-S

1. Tools Required

The following tools will be required to install battery only (Use S22-M-H and S22-S stacked).



2. Packing List

For S22-M-H:

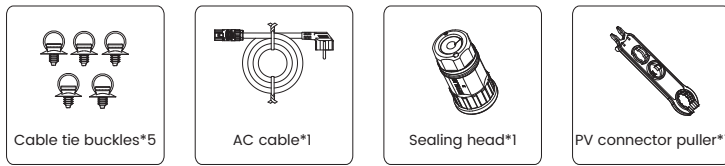

For S22-S:

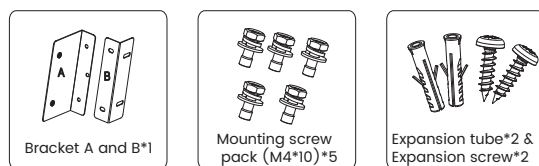

3. Product Overview

For S22-M-H:

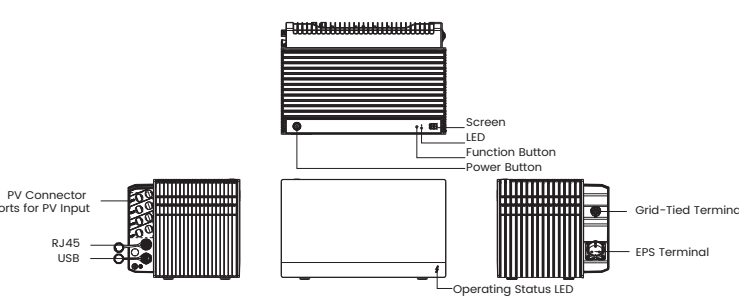

For S22-S:

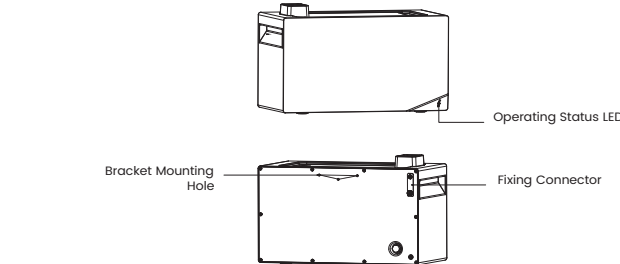

4. Installation Steps

Scenario 1- Use S22-M-H alone:

The following figure shows an example of S22-M-H paired with four PV panels.

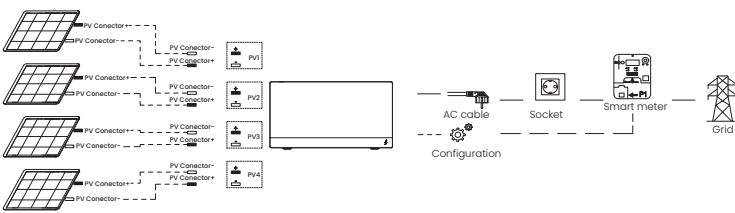

Scenario 2 - Use S22-M-H and S22-S stacked:

The following figure shows an example of 1 S22-M-H and 2 S22-S paired with four PV panels.

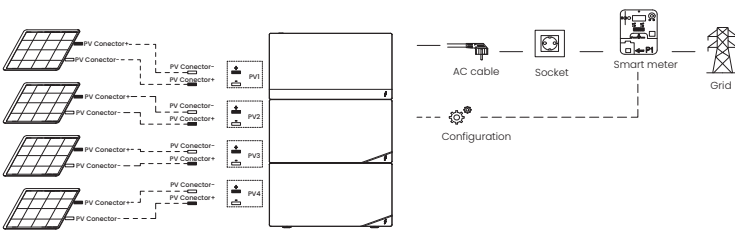

Note: The following installation steps are applicable for installing extended batteries.

Step 1

Install the dust covers of the bottom S22-S and remove the other dust covers.

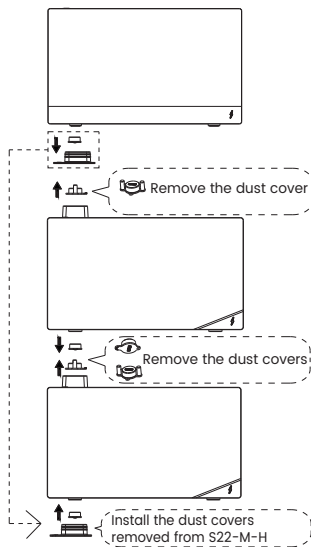

Step 2

Lock bracket A to the rear cover of the battery with screws (M4*10).

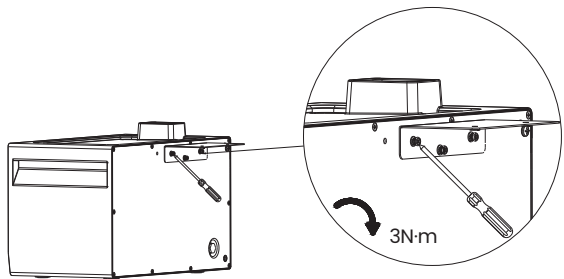

Step 3

Lock bracket B to bracket A and move the battery to a suitable position against the wall and mark the bracket holes on the wall with a marker.

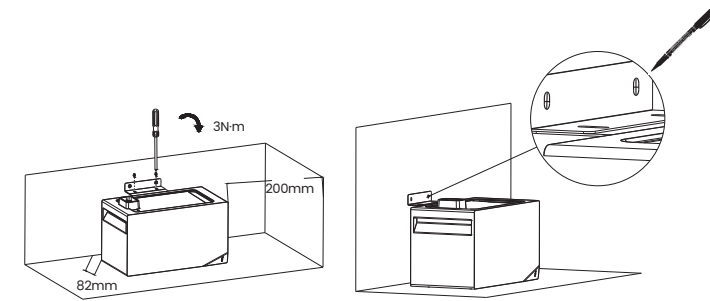

Step 4

Note: Remove the battery before drilling.

Drill $\phi 8 \times 40$ mm or deeper holes at the two markers, hammer the expansion tubes into the holes, and then use a screwdriver to fasten the two M6*40 expansion screws to the bracket B.

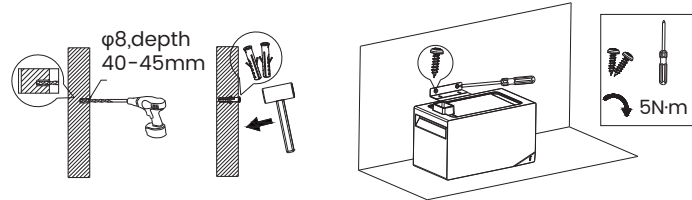

Step 5

Install the required stacked battery in the orientation shown in the figure.

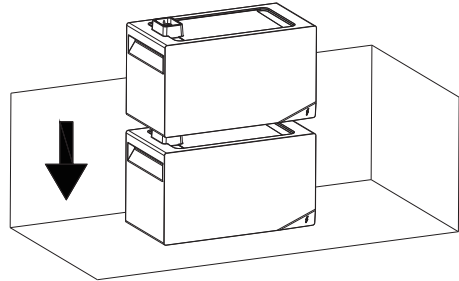

Step 6

Rotate the fixing connector to the corresponding hole of the upper battery and tighten the screw to fix it.

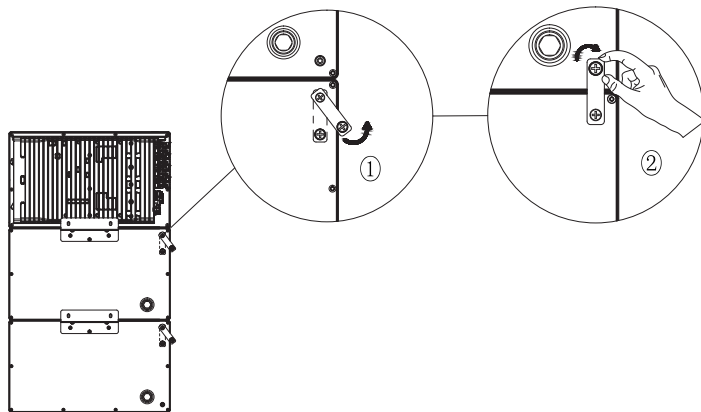

Note: Ensure that each system has only one unit of S22-M-H and a maximum of four units of S22-S.

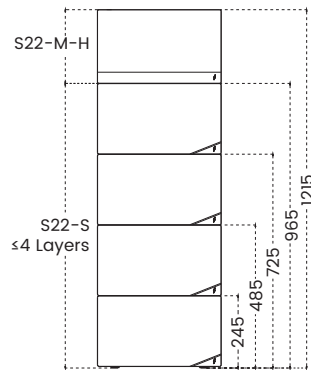

5. Electrical Connections

1. Connect S22-M-H to a home outlet using the included AC Cable.

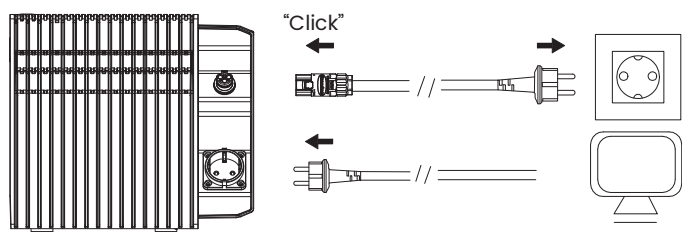

2. Find the PV connector ports of your solar panels.

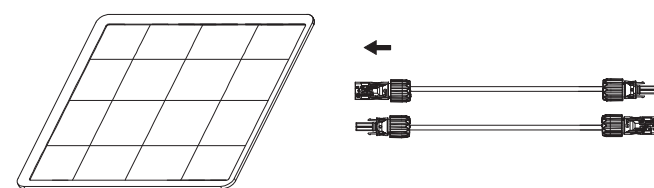

3. Connect each PV module directly to the same set of PV input ports.

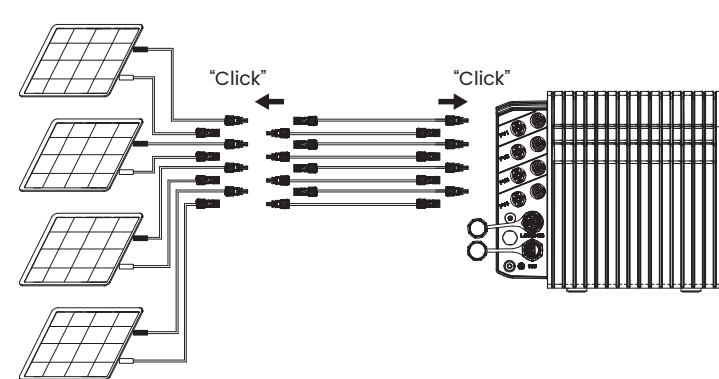

Note:

- Ensure that unused PV ports on Orbit-M are sealed with waterproof caps.
- When connecting PV modules in parallel, please check the specifications of the PV modules and ensure that the total short-circuit current does not exceed 25A.
- Never connect the same set of PV connectors to different sets of PV input ports.
- Never connect PV modules in series because this causes the input voltage to exceed 60V and will damage the equipment.

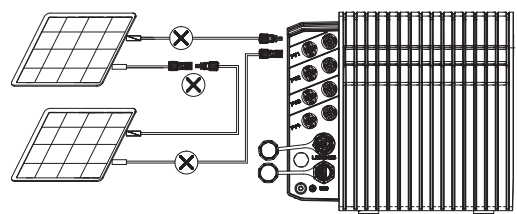

4. If you want to disconnect the PV connector: After ensuring the system is turned off, use the included wrench to safely remove the PV connector.

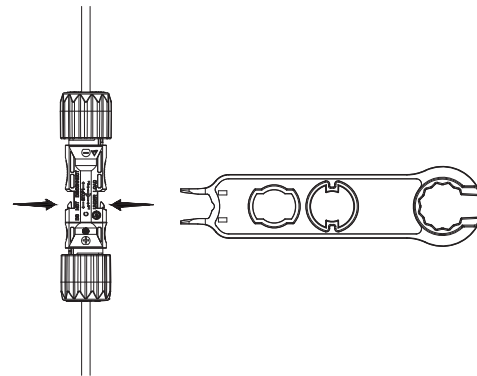

6. System Operation

All installation and operation must comply with local electrical standards. Check all power cables carefully.

Button	Action	Function
	Press for 2 Seconds (in power off state)	Turn on the battery
	Press for 2 Seconds (in power on state)	Enable/disable EPS output
	Press for 5 Seconds (in power on state)	Turn off the battery
	Press for 2 Seconds (in screen off state)	Light up the screen
	Press for 2 Seconds (in screen on state)	Switch the screen page
	Press for 20 Seconds	Reset bluetooth and Wi-Fi

7. APP Configuration

Download the app compatible with your system.



Scan the QR code below to read the configuration guide.



8. Smart Meter Configuration

Please scan the QR code below to get the latest supported smart meters and specific configuration methods for various models of smart meters.



9. User Manual

Please scan the QR Code and follow the steps below to download our latest multi-language User Manual/Quick Installation Guide:
Scan the QR Code → Select your Language → Choose to download User Manual or Quick Installation Guide → Download

