

**Fox ESS EV Charger
User Manual**



FOXESS CO., LTD.

Copyright © FOXESS CO., LTD. 2022. All rights reserved.

No part of this document may be reproduced or transmitted in any form or by any means without prior written consent of FOXESS CO., LTD.

Trademarks and Permissions



and other Fox ESS trademarks are trademarks of FOXESS CO., LTD.

All other trademarks and trade names mentioned in this document are the property of their respective holders.

Notice

The purchased products, services and features are stipulated by the contract made between Fox ESS and the customer. All or part of the products, services and features described in this document may not be within the purchase scope or the usage scope. Unless otherwise specified in the contract, all statements, information, and recommendations in this document are provided "AS IS" without warranties, guarantees or representations of any kind, either express or implied.

The information in this document is subject to change without notice. Every effort has been made in this preparation of this document to ensure accuracy of the contents, but all statements, information, and recommendations in this document do not constitute a warranty of any kind, express or implied.

FOXESS CO., LTD.

Address: No.939, Jinhai Third Road, New Airport Industry Area, Longwan District, Wenzhou, Zhejiang, China

Website: WWW.FOX-ESS.COM

Contents

1 Download and Install the APP	1
2 Account Register	2
3 Log in	4
4 Adding, binding and Bluetooth connection of EV Charger	5
4.1 Add and Bind EV Charger	5
4.2 Connect the EV Charger with Bluetooth	6
5 EV Charger network connection setting	7
6 EV Charger Function Setting	10
6.1 Charging Mode Setting	10
6.2 Appointment Charging Setting	10
6.3 Charging Current Setting	11
6.4 Load Balance Setting	11
6.5 Photovoltaic Linkage Setting	12
6.6 Meter Ratio setting	12
6.7 Station-Level Load Balance Setting	13
7 RFID card management	15
7.1 Add the RFID Card	15
7.2 Delete RFID card	15
8 Other Setting	16
8.1 Fault	16
8.2 Firmware Upgrade	16
8.3 About	17
9 Records	18
10 Personal Center	19

1 Download and Install the APP

You can download and install the APP by scanning the QR Code or searching for "FoxSwitch" in the App Store and Google Play.





2 Account Register

The first time you use the FoxSwitch APP, You'll need to register an account.

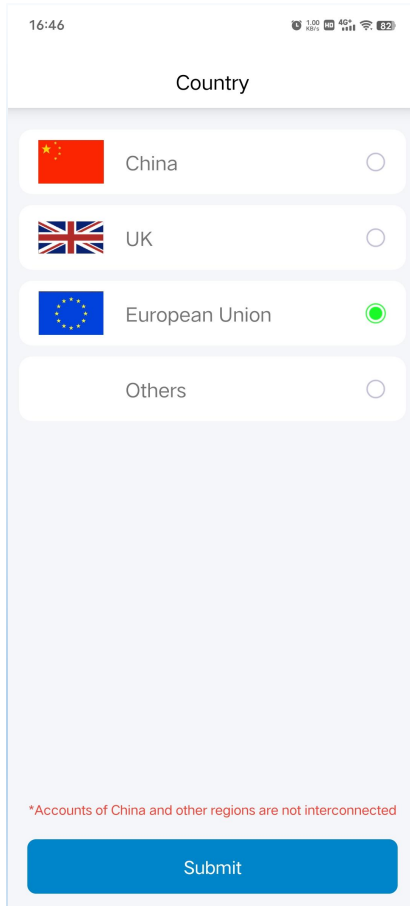
- Open the APP, select a country or region. Please select your country or region.



The screenshot shows a mobile app interface for selecting a country or region. At the top, the status bar displays the time 16:46, battery level at 100%, and network status (4G+). Below the status bar is a header labeled "Country". The main content area contains four selectable options, each with a flag icon, a text label, and a radio button:

-  China ☐
-  UK ☐
-  European Union ☒
- Others ☐

Below these options is a large, empty light blue rectangular area. At the bottom of the screen, there is a red text warning: "*Accounts of China and other regions are not interconnected". At the very bottom is a blue rectangular button with the text "Submit".

- **Permission granting**

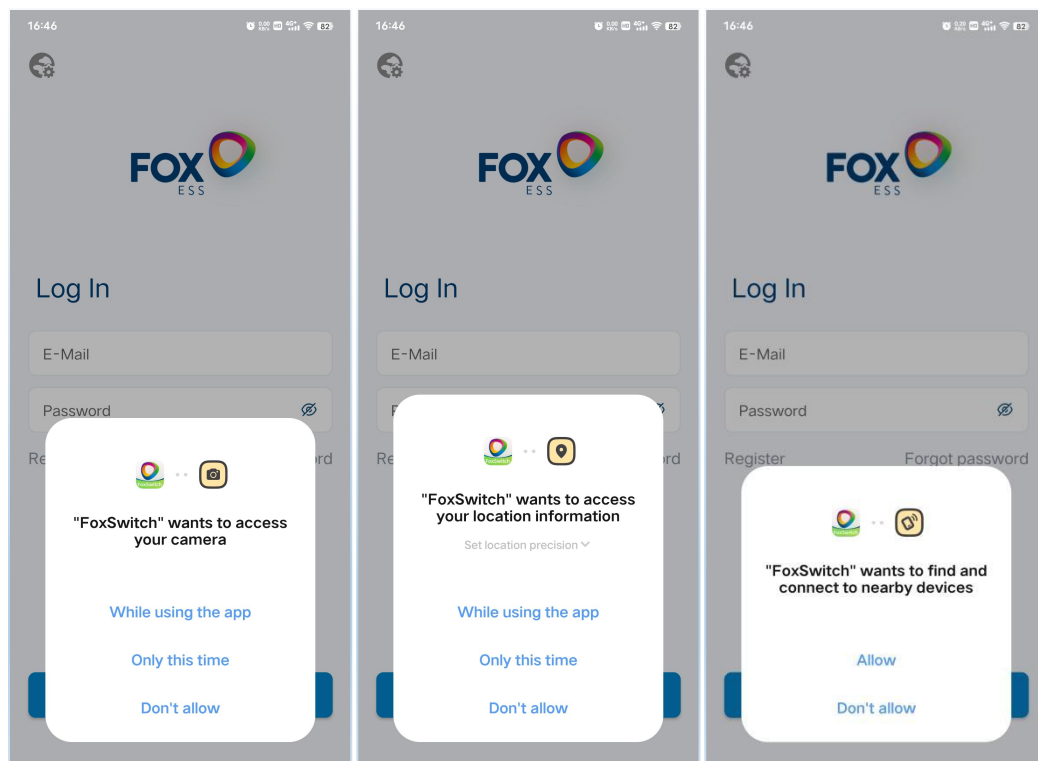

In order to use FoxSwitch APP normally, please authorize necessary permissions such as camera, positioning, and Bluetooth.

- **Fill in Account Register Information**

The image shows the 'Register' screen of the FOX ESS app. At the top, there is a back arrow and the word 'Register'. Below the FOX ESS logo, the title 'Register' is displayed. The form contains the following fields and elements:

- E-Mail:** A text input field.
- Verification Code:** A text input field with a blue button labeled 'Verification Code' to its right.
- Password:** A text input field.
- Confirm password:** A text input field.
- Agreement:** A checkbox followed by the text 'I have read and agreed to the terms and contents defined in the "User Agreement"'. The checkbox is currently unchecked.
- Register Button:** A large blue button at the bottom labeled 'Register'.

- Enter your E-mail and click Verification Code. Check the received verification code in your E-mail and fill it in the verification code input box. Enter your password and verify again, check and agree with the User Agreement, and then click Register.

3 Log in

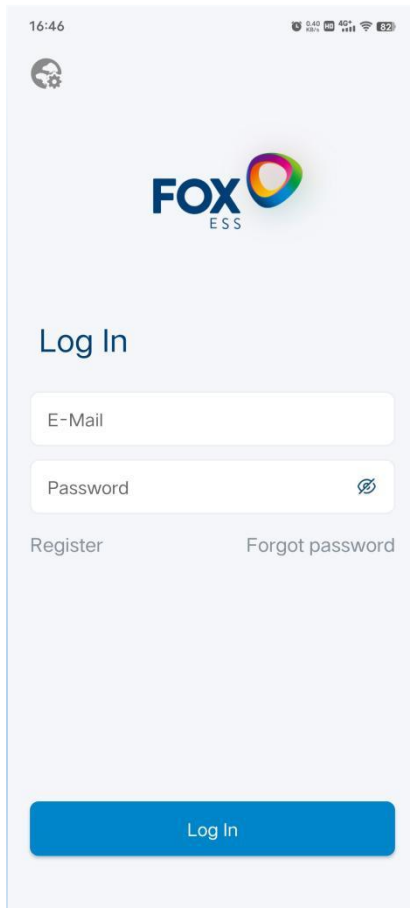

16:46 0.42 4G+ 100% 42

FOX
ESS

Log In

E-Mail

Password

Register Forgot password

Log In

- You shall log in for the first time with the registered account and password, and may log in with the account and password recorded in the phone when log in next time.
- If you have questions about the entered password, please click the icon on the right side of the password box to display or hide the password.
- If you have forgotten the account login password, please click the Forget password? option to reset the password.
- You can also click the Register button in this page to register a new account.

4 Adding, binding and Bluetooth connection of EV Charger

4.1 Add and Bind EV Charger

- Click the Add button in the Home of the APP

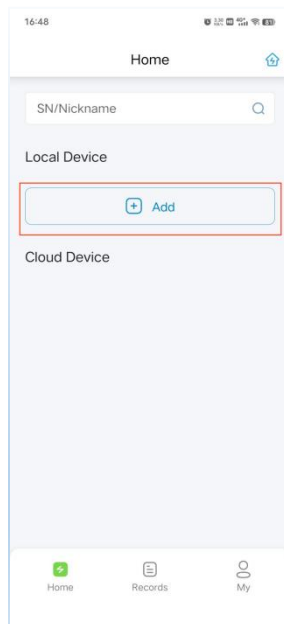

- You can scan the QR Code of the EV Charger or manually enter the SN of the EV Charger, enter the name of the EV Charger, and click the Confirm button to add and bind EV Charger, the EV Charger will be displayed in the list of Local Device after the binding is completed.

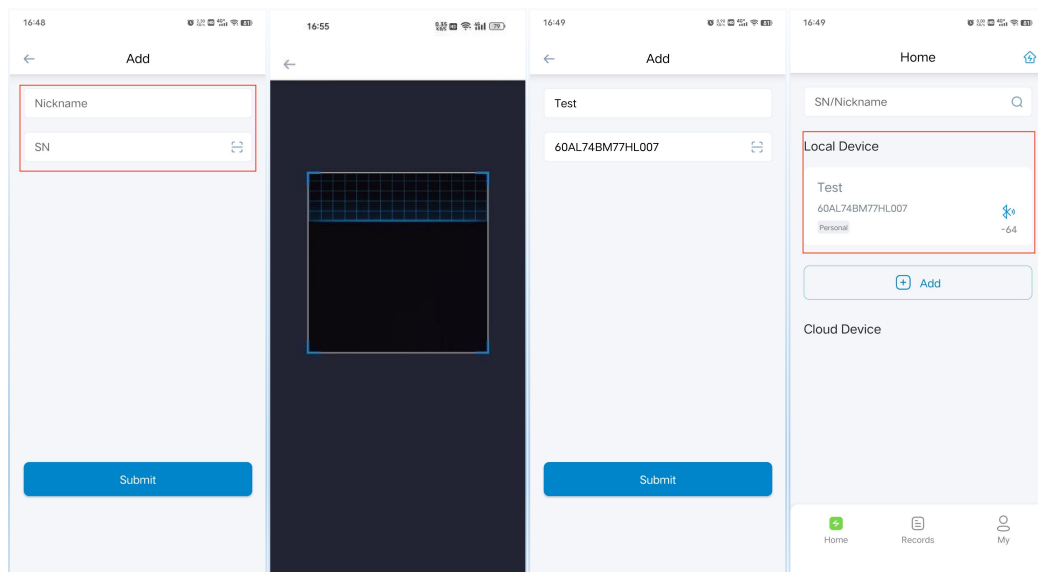

4.2. Connect the EV Charger with Bluetooth

- Click the Bluetooth icon of the bound EV Charger to connect via Bluetooth and enter the EV Charger Control interface.

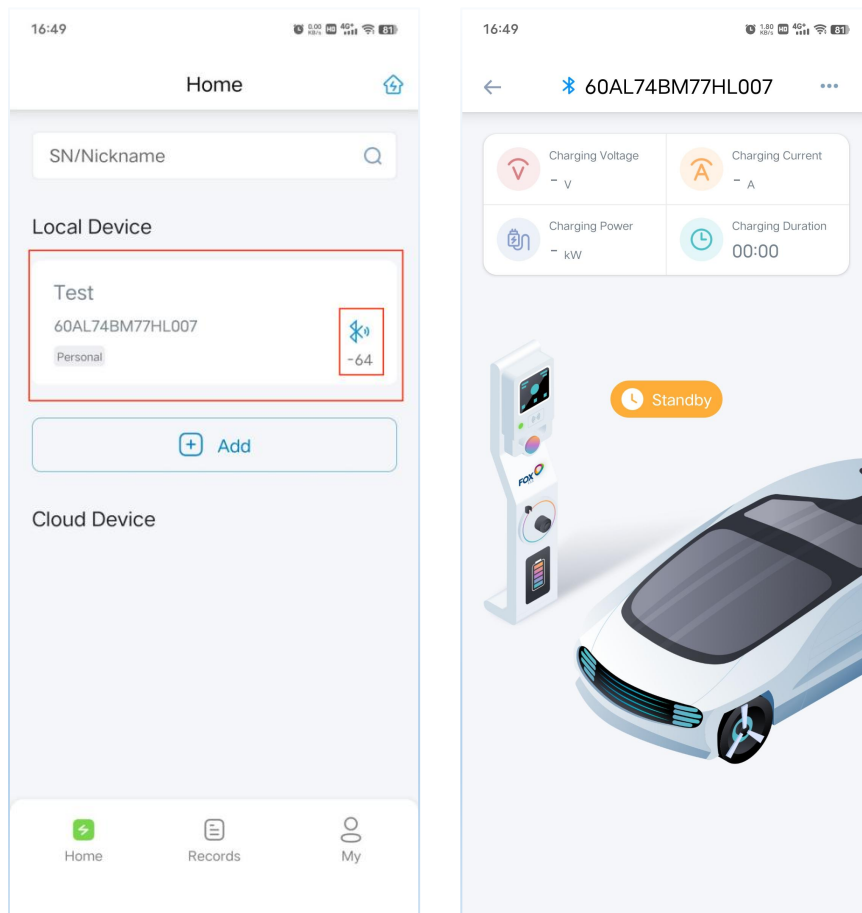

Note: To ensure the stability of Bluetooth connection, please connect to the EV charger 3 minutes after powering on the EV charger. In the Bluetooth mode, you may enter the EV Charger Control interface to set the EV charger.

5 EV Charger network connection setting

- Click the Bluetooth icon of the bound EV Charger to connect via Bluetooth and enter the EV Charger Control interface.

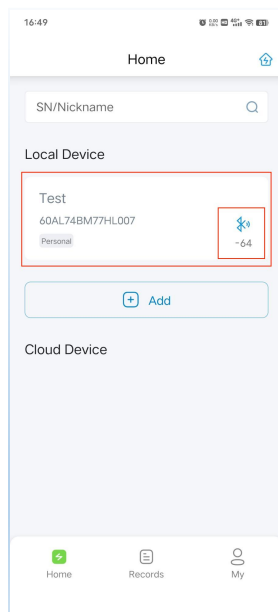

- Click the button in the upper right corner of the EV Charger control interface, select the Network Setting menu, enter the EV Charger Network Setting interface, click the WIFI Parameter Setting button at the top and enter the WIFI name and password, then click the Setting button to complete WIFI network Setting; if your EV Charger has 4G network configuration, please click the 4G Parameter Setting button at the top and then directly click the Setting button to complete 4G Network Setting. The EV Charger connected to the network will be displayed in the Cloud Device List.

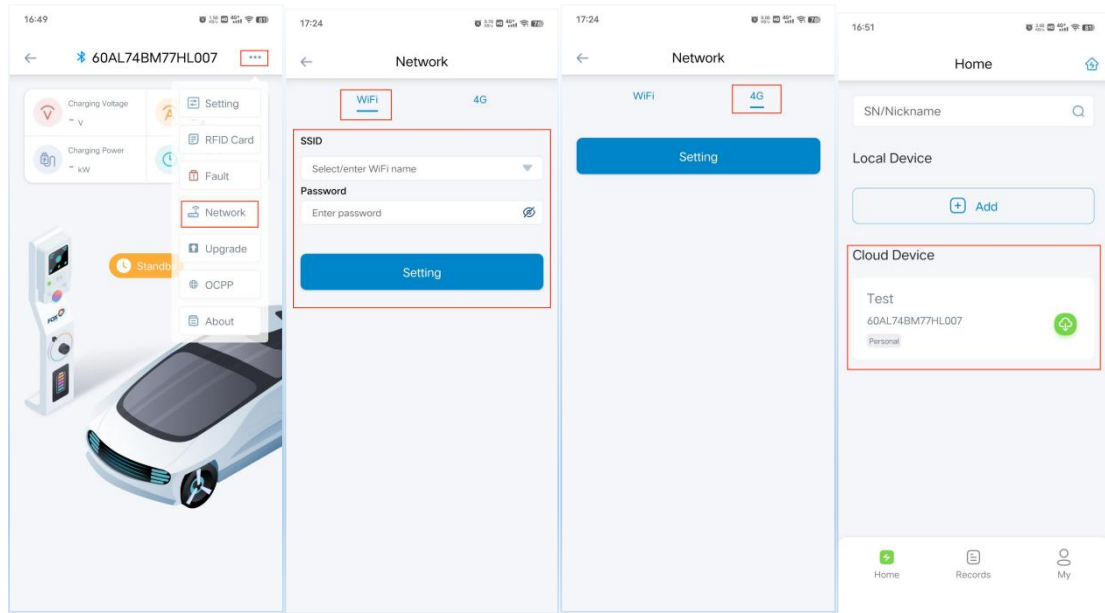

- If your EV charger contains OCPP configuration, you will see the DHCP Setting option in the WIFI Setting interface. DHCP is enabled by default to automatically obtain the IP address; if you need to manually set the IP address, please disable DHCP. The 4G Network Setting interface includes OCPP configuration, the SIM cards of some carriers need to configure APN parameters before they can access the data network. In most cases, you do not need to configure APN because these parameters will be automatically obtained from the base station. All parameters can be kept as default. If configuration is required, you will obtain these parameters from your network carrier.

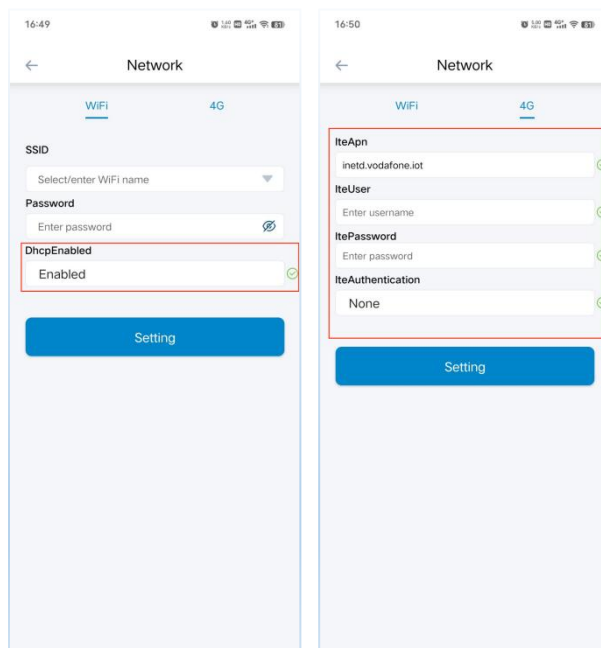

Note: In order to ensure the network configuration stability, it is recommended to cut off power supply and restart the EV Charger after network configuration. You can connect to the network and enter the Cloud within 3 minutes after restarting. In Cloud mode, the upload interval of EV Charger charging data to the APP is 1 minute. 4G hardware is optional, please confirm whether this function is available to your EV Charger.

- If your EV charger is equipped with OCPP hardware, you can click the "OCPP" button in the EV charger control interface to enter the OCPP Setting interface. If you need to use the OCPP function, please ask the operator of the charging platform for the server URL address of the platform, enter the server URL address of the platform in the "OCPP URL" of the OCPP setting interface, and click "Completed" to complete OCPP configuration.

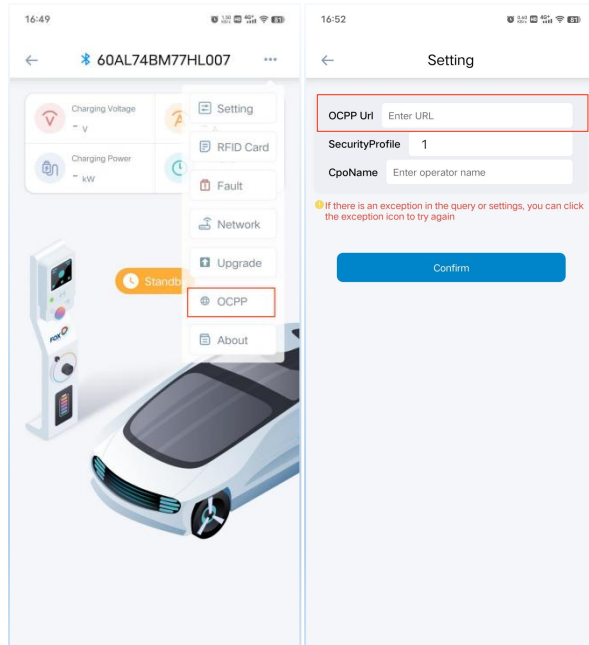

Note: OCPP is optional, please confirm if this function is available to your EV charger.

6 EV Charger Function Setting

6.1 Charging Mode Setting

- Click the "Setting" button in the EV Charger Control interface to enter the EV Charger Setting interface. You can set the charging mode of the EV charger to "Plug and Play Mode", "Controlled Mode", and "Locking Mode".

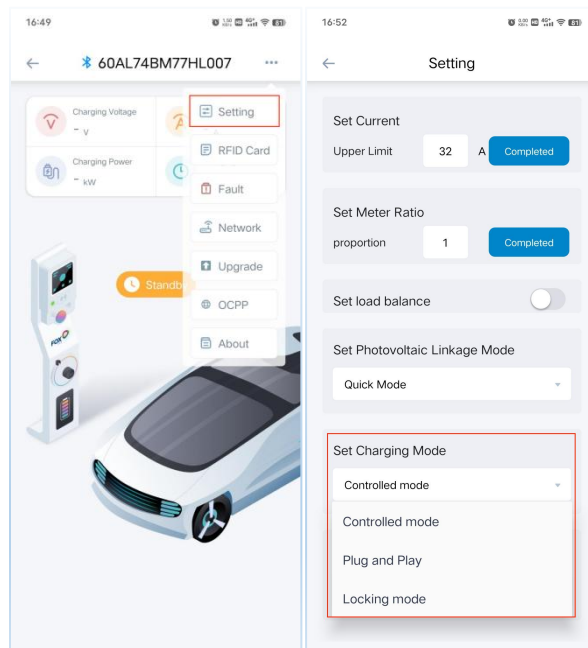

Note: The Charging mode can only be set in the standby and idle state.

6.2 Appointment Charging Setting

- In the EV Charger Setting interface, you can set the Appointment Charging Time. You can choose "Single" or "Cycle", where "Single" means you can set the appointment charging time for the current day; Cycle means that you can set the appointment charging time for one week and set the appointment charging time for every day.

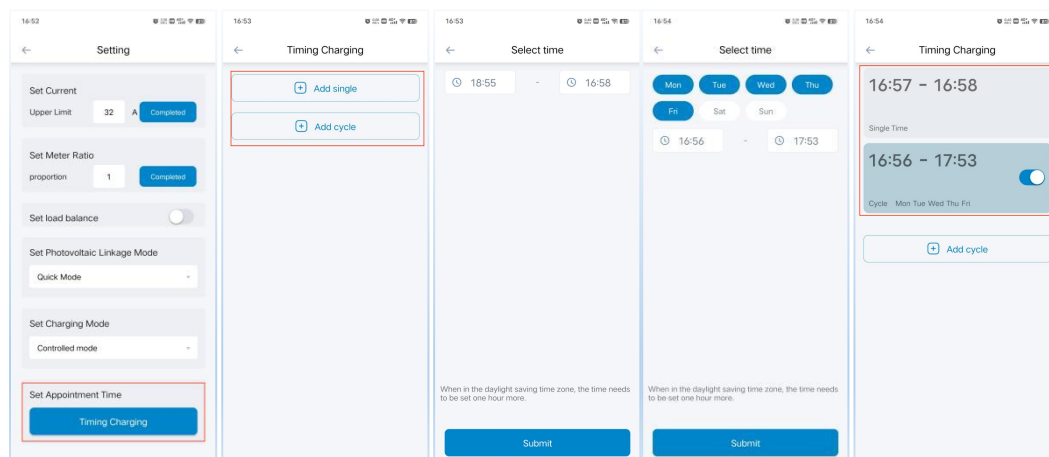

Note: For scheduled charging, only the scheduled charging time can be set in the standby state in controlled mode.

6.3 Charging Current Setting

- In the EV Charger Setting interface, you can set the maximum charging current of the EV Charger.

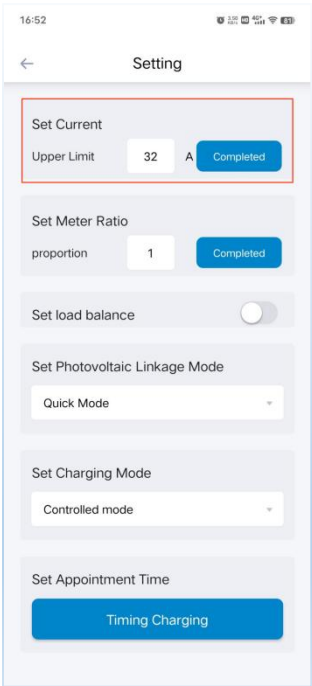

Note: The current range that can be set is 6~32A

6.4 Load Balance Setting

- In the EV Charger Setting interface, you can turn on the load balance function switch and set the load balance current.

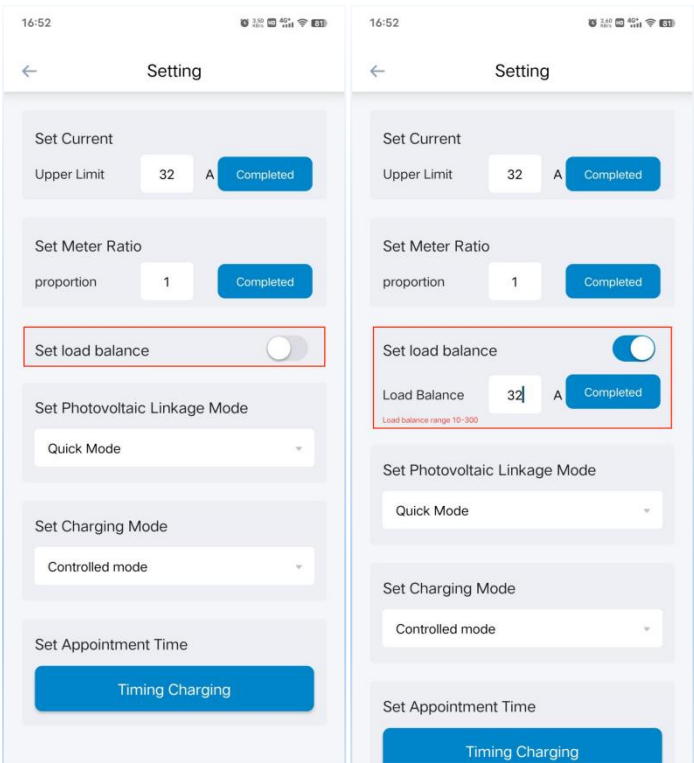

6.5 Photovoltaic Linkage Setting

- In the EV charger Setting interface, you can set the photovoltaic linkage mode to "FAST Mode", "ECO Mode" and "GREEN Mode".

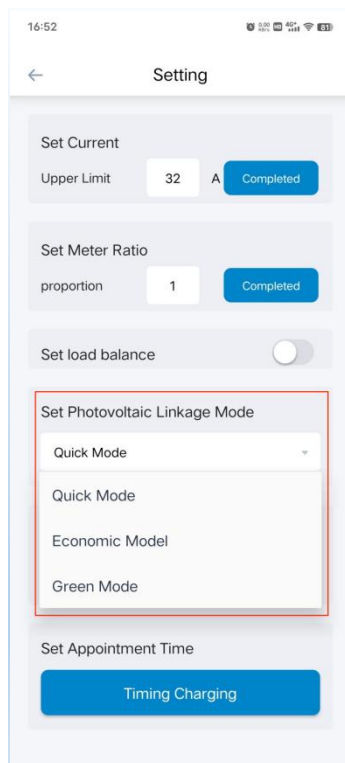

6.6 Meter Ratio setting

- In the EV Charger Setting interface, you can set the corresponding Meter Ratio according to the type of installed electric meter. The default setting for direct-connected meter is 1. For CT meter, please set it according to the ratio corresponding to CT.

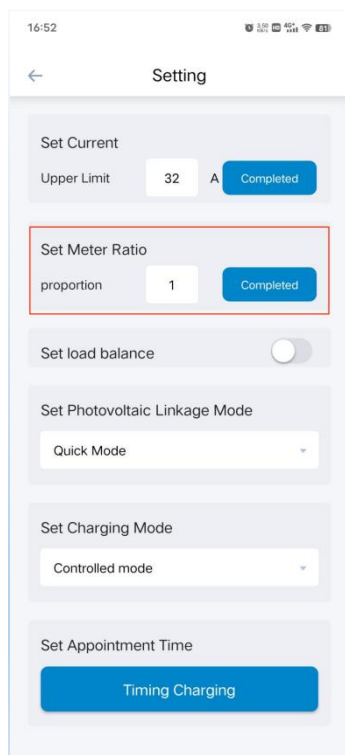

6.7 Station-Level Load Balance Setting

(1) Establish a New Power Station and Add EV Charger

- Click on the My Power Station icon in the upper right corner of the APP Home to enter the My Station interface. Click on the New Station icon in the upper right corner, enter the name of the station, and confirm to establish the station.

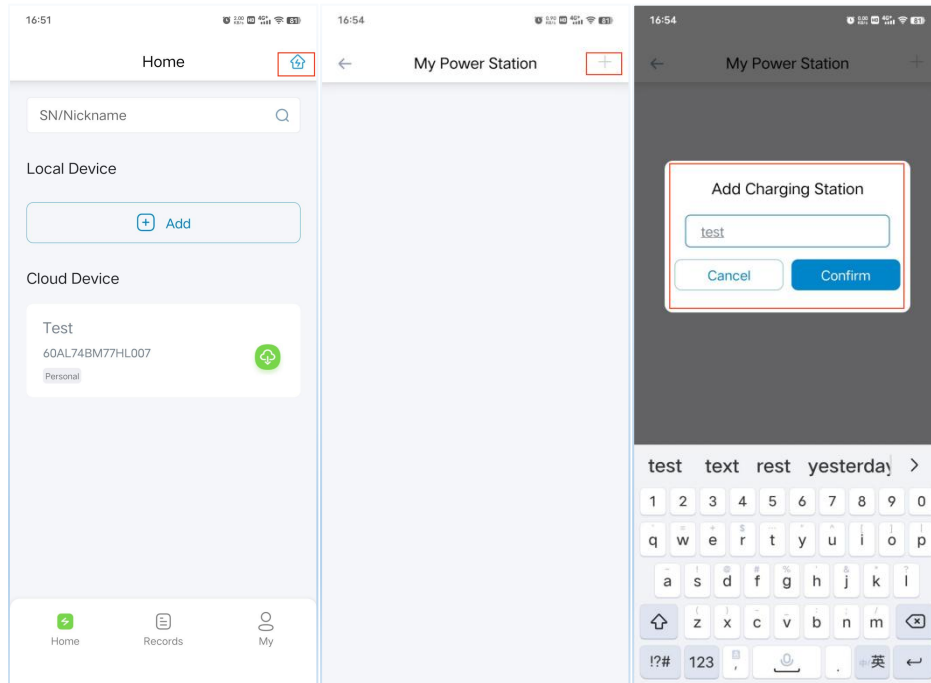

- Click on the established station to enter the Power Station Setting interface, click the Add icon on the right side of the Device List, select the EV Charger SN that needs to be added to the station, and click Confirm to complete adding the EV Charger.

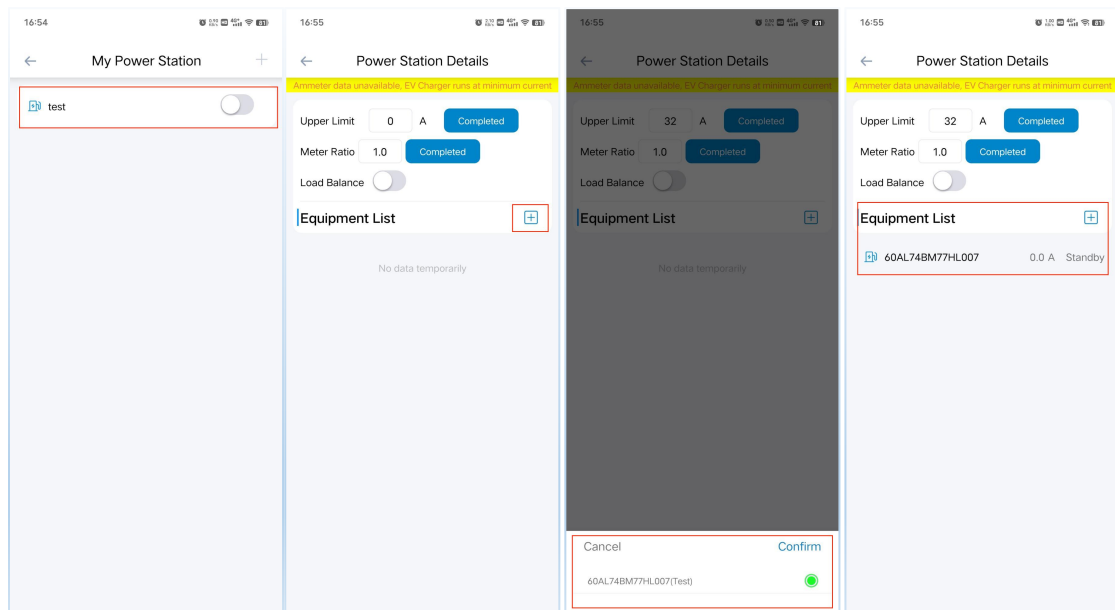

Note: The EV Charger must be connected to the network (WIFI/4G) and in online state before it is added in the station.

(2) Station Load Balance Parameters Setting

- In the Station Setting interface, you can set the load balance current and load balance switch of the station, and set the Grouping Ratio based on the electricity meter you are connected to.

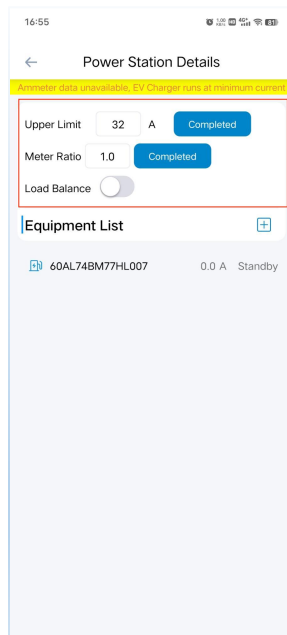

7 RFID card management

7.1 Add the RFID Card

- Click the "RFID Card" button in the EV Charger Control interface to enter the RFID Card Management interface. Click the "Add" button to hear a beep, place the RFID Card in the card reading area of the EV Charger, and enter the card name to add it into the RFID Card. The RFID card can be used to control the start and stop of the EV Charger.

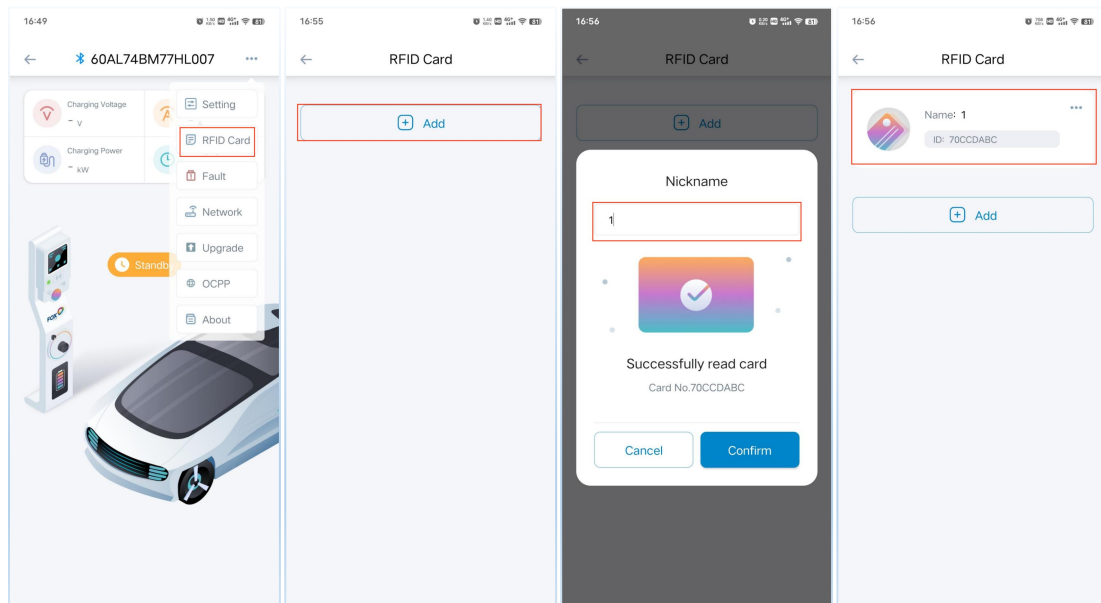

Note: The EV charger is provided with two RFID cards, and at most 8 RFID cards can be added to one EV charger.

7.2 Delete RFID card

- Click the three-dot icon in the upper right corner of the RFID card to be deleted, and click the pop-up Delete button to delete the RFID card.

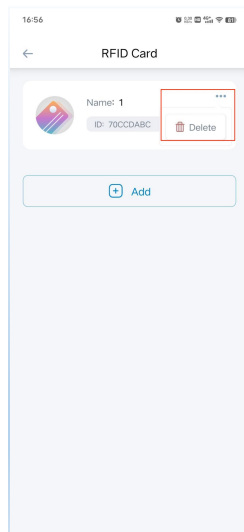

8 Other Setting

8.1 Fault

- Click the "Fault" button in the EV Charger Control interface to enter the Fault Alarm interface, where you can check the current fault information of the EV charger.

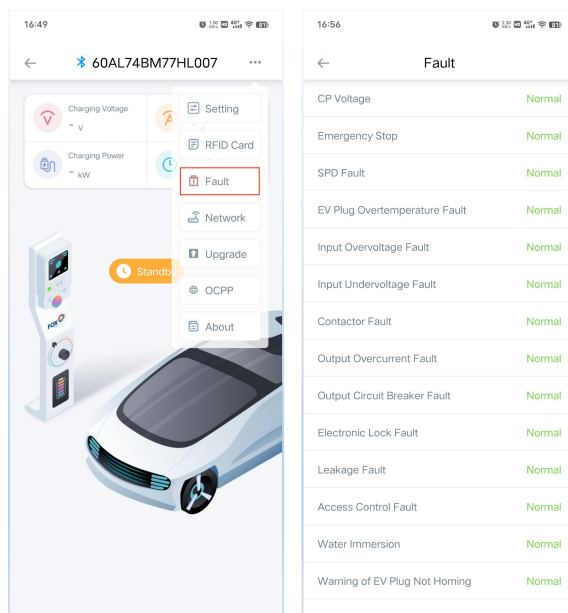

8.2 Firmware Upgrade

- Click the "Upgrade" button in the EV Charger Control interface to upgrade the firmware.

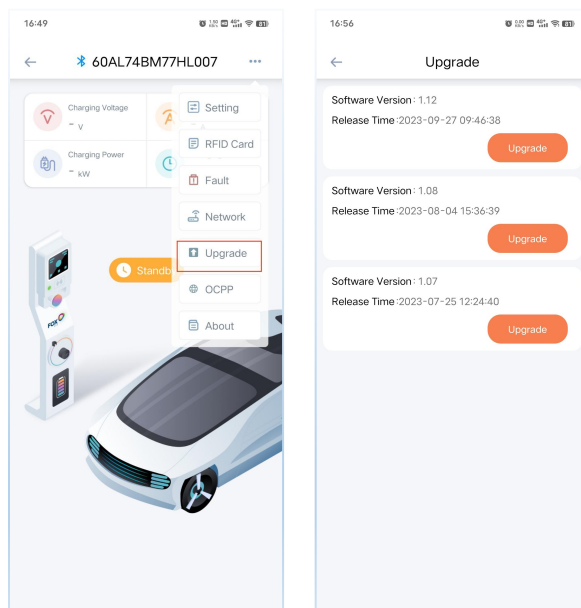

Note: To ensure the firmware upgrade stability, it is recommended to perform upgrade when the EV Charger is in standby mode.

8.3 About

- Click the "About" button in the EV Charger Control interface to check information such as the Model, SN, and Firmware Version of the EV charger.

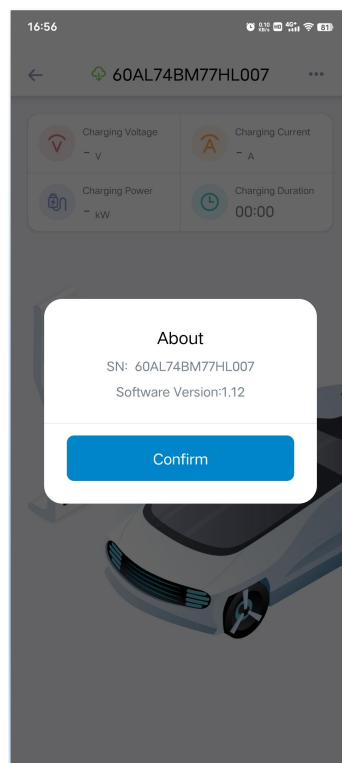
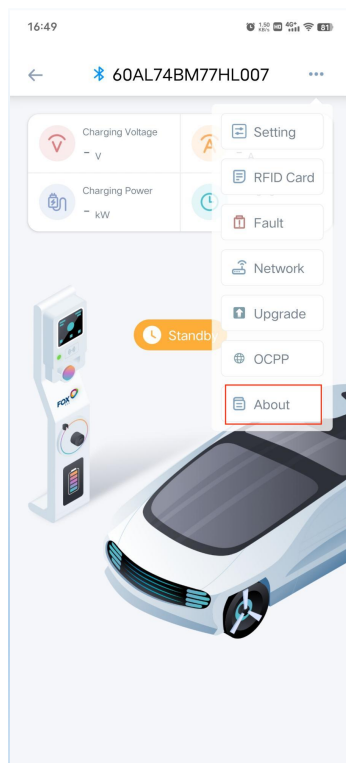

9 Records

- In the Records interface, you can check the charging information of the EV charger under the current account, including Charging Time, Charged Amount, Charging Duration, etc.

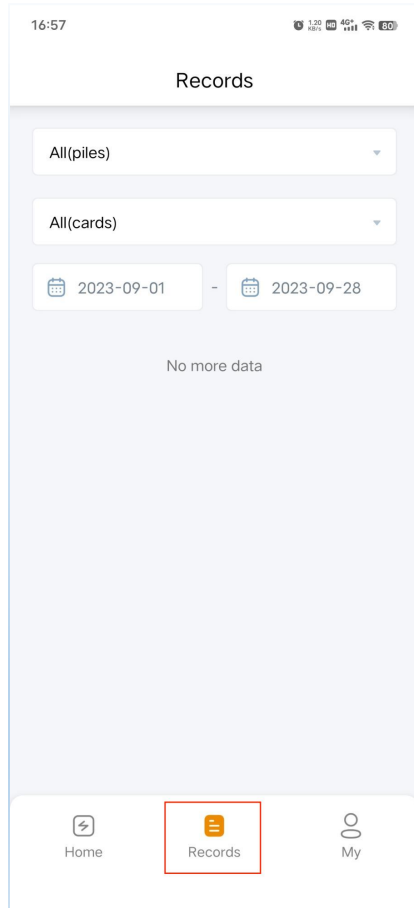

10 Personal Center

- In the Personal Center interface, you can check the personal account information and APP Version Number, Reset Password etc.

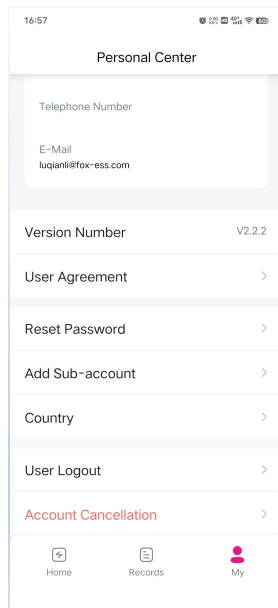

- In the Personal Center interface, you can also add Sub-accounts, and the authorized Sub-accounts can also control the EV chargers under the account.

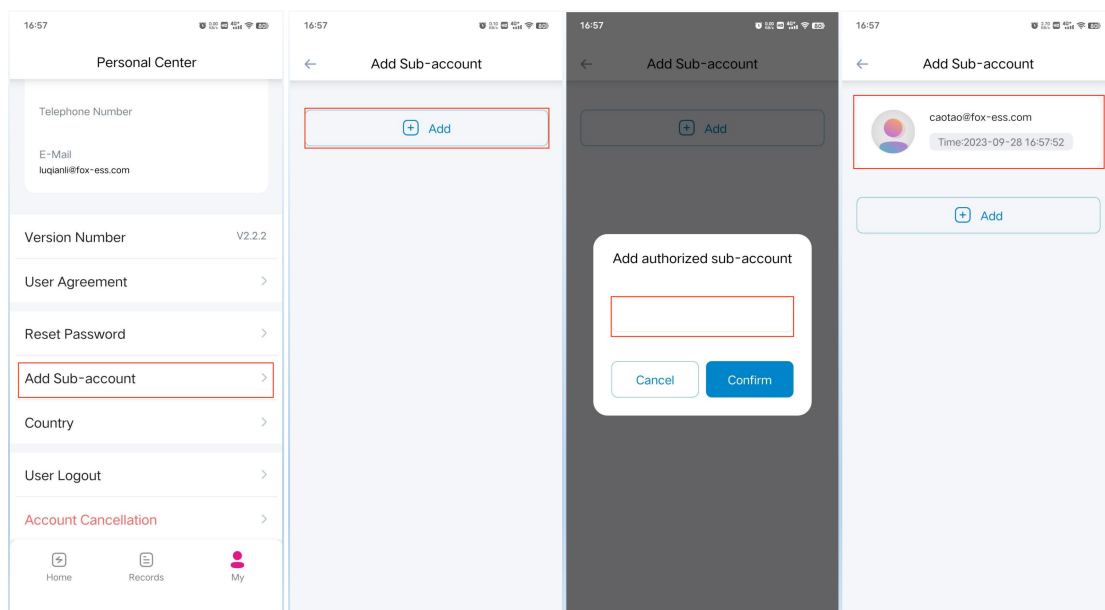

Note: Authorized sub-account should be registered in FoxSwitch in advance, and each account can authorize up to 10 sub-accounts.